

1 Female TOILET VANITY
SCALE : 1:10

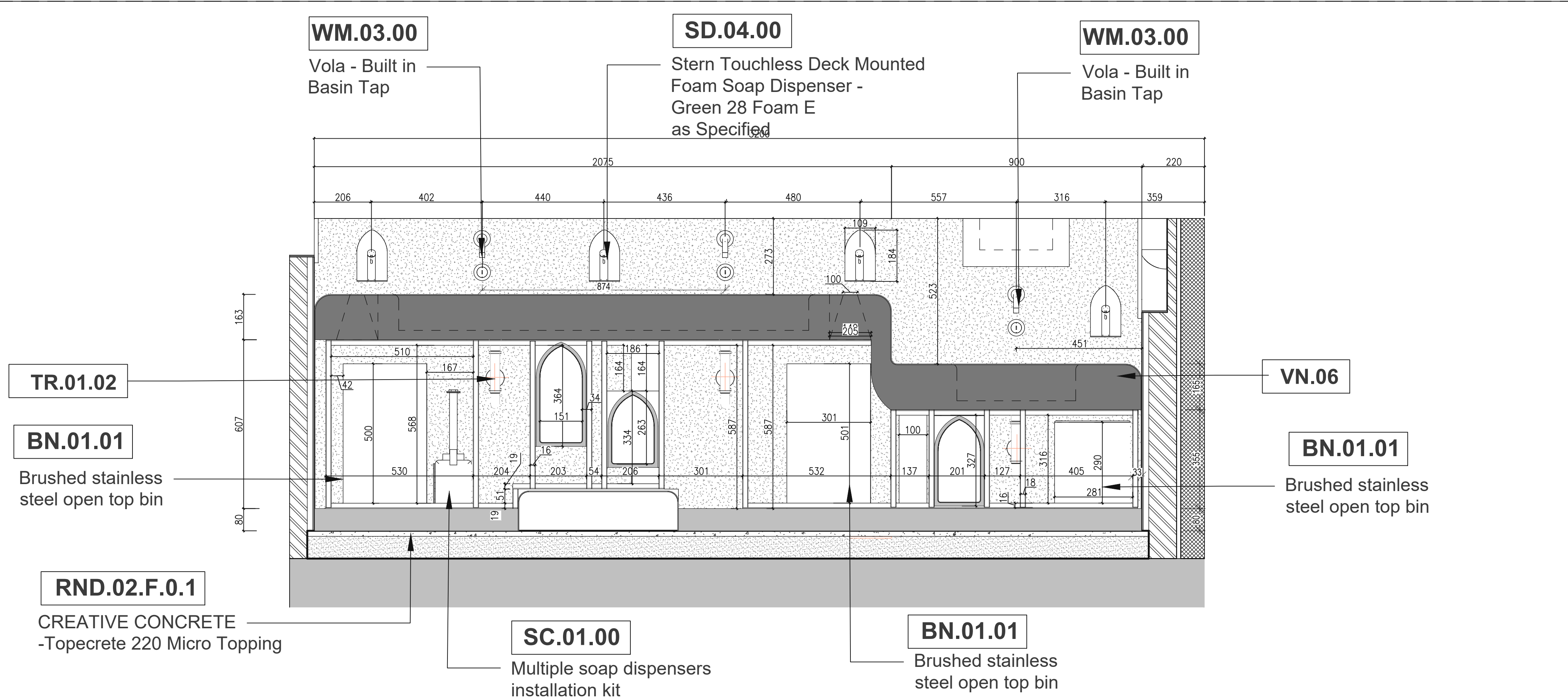

2 Female Toilet Vanity Section
SCALE : 1:10

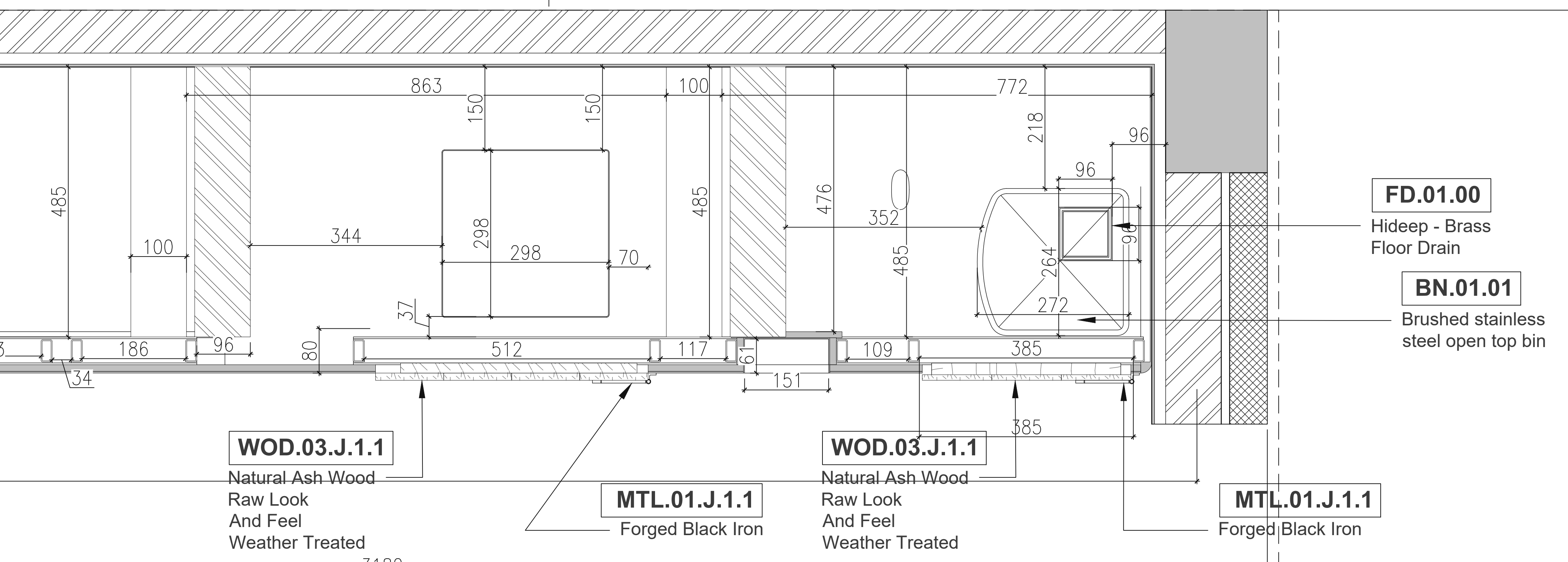

5 BLOW-UP DETAIL 01
SCALE : 1:5

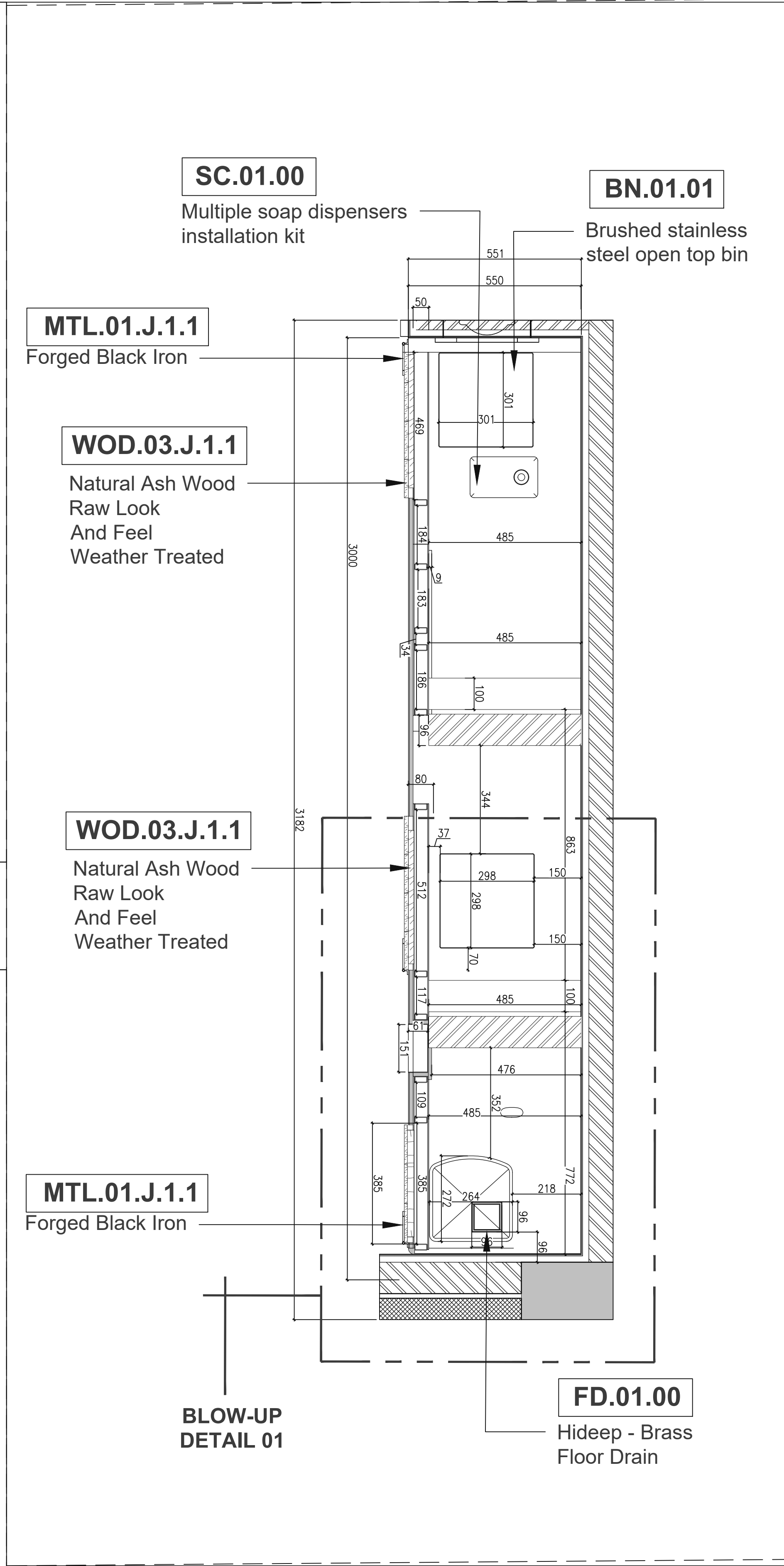

3 Female Toilet Vanity Cut Plan
SCALE : 1:10

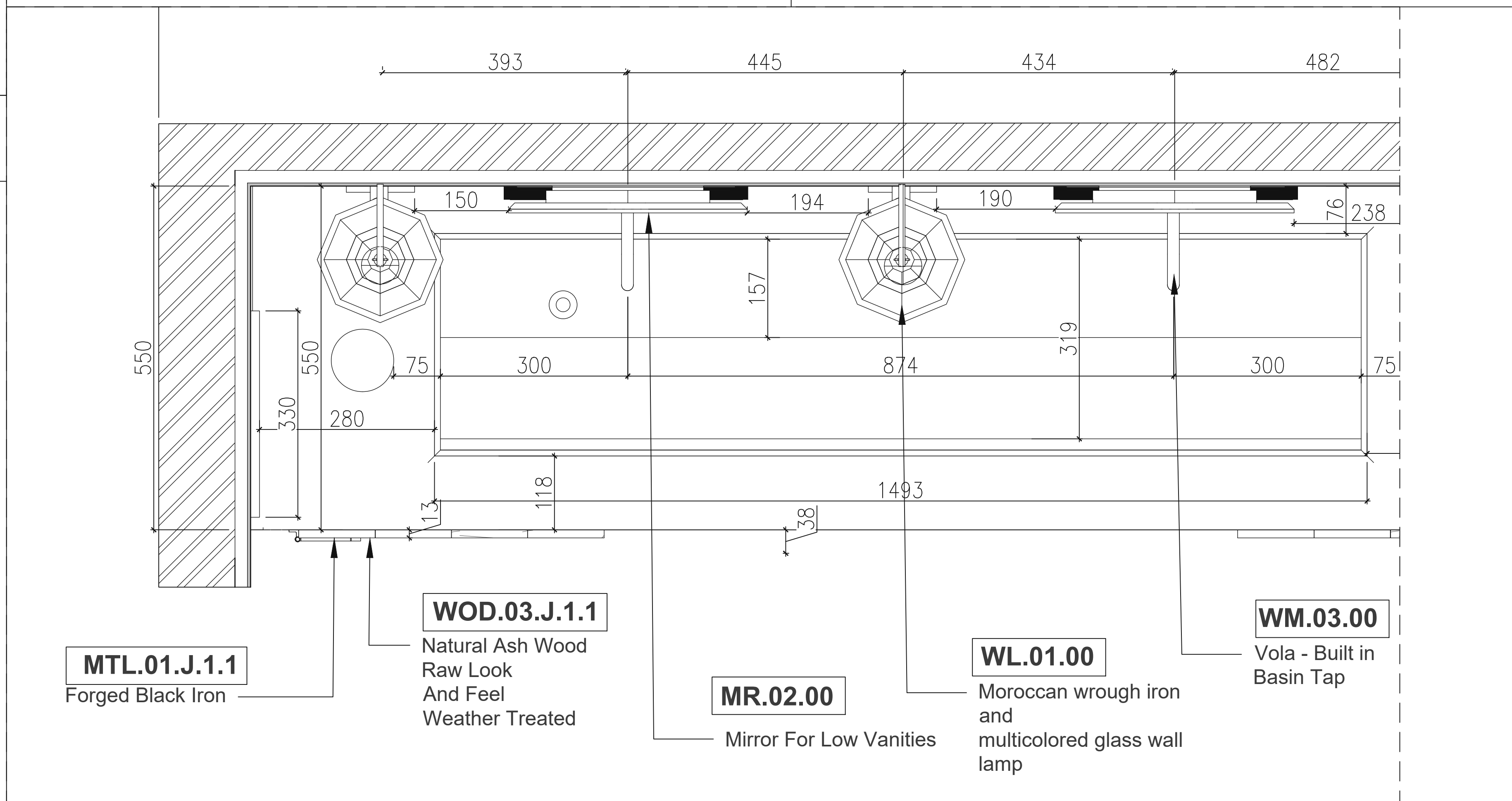

6 BLOW-UP DETAIL 02
SCALE : 1:5

LAND KEY :		 MECCA	
GENERAL NOTES :			
1. THIS DRAWING MUST BE READ IN CONJUNCTION WITH SPECIFICATION AND SCHEDULES AND RELEVANT ARCHITECTURAL, STRUCTURAL AND MEP DRAWINGS.			
2. ANY DISCREPANCY IN OR BETWEEN THE DRAWINGS, ATTENTION OF THE ENGINEER PRIOR TO UNDERTAKING ANY WORKS.			
3. ALL OTHER SERVICES SHOWN ARE PURELY INDICATIVE AND MUST BE VERIFIED AND COORDINATED BY QUALIFIED AGENCIES PRIOR TO THE COMMENCEMENT OF ANY WORK ON SITE.			
4. ALL DIMENSIONS SHOWN ARE IN MILLIMETERS AND DO NOT TAKE INTO ACCOUNT APPLIED FINISHES UNLESS SPECIFICALLY INDICATED OTHERWISE. ONLY FIGURED DIMENSIONS TO BE FOLLOWED. DO NOT SCALE DRAWING.			
5. FOR SETTING OUT INFORMATION REFER TO ARCHITECTURAL DRAWINGS. DO NOT SET OUT FROM THIS DRAWING.			
6. THE CONTRACTOR SHALL SUBMIT COORDINATED SHOP DRAWINGS FOR APPROVAL (BASED ON SITE DIMENSIONS) PRIOR TO COMMENCEMENT OF ANY SITE WORKS OR PLACING OF ANY ORDERS AND/OR MANUFACTURE OF ANY FITTINGS, FIXTURES AND COMPONENTS AS SHOWN. THE CONTRACTOR SHALL ONLY WORK ON COORDINATED AND APPROVED SHOP DRAWINGS.			
7. ALL MATERIALS SHALL BE APPROVED BY THE ENGINEER/ARCHITECT PRIOR TO UNDERTAKING ANY WORKS.			
8. CONTRACTORS TO PROVIDE ADEQUATE FIXING GROUNDS WITHIN ALL WALLS / PARTITIONS / CEILING TO SUIT AND SUPPORT NEW ELEMENTS THROUGHOUT THE SCHEME. CONTRACTOR TO ENSURE STABILITY OF ALL CONSTRUCTION.			
9. ALL CONSTRUCTION AND MATERIALS TO COMPLY WITH CURRENT MUNICIPAL AND CIVIL DEFENSE AND BUILDING REGULATIONS.			
10. THIS DRAWING IS ISSUED ON CONDITION THAT IT IS NOT COPIED, REPRODUCED, RETAINED OR DISCLOSED TO ANY UNAUTHORIZED PERSON EITHER WHOLE OR IN PART.			
11. FOR SUBSTRATE AND MATERIAL BEHIND ID FINISHES, SEE OTHER DRAWING SPECIFICATIONS BY OTHER DISCIPLINE.			
OWNER:			
EMPLOYER:			
PROJECT MANAGEMENT CONSULTANT			
LEAD DESIGN CONSULTANT :			
ARCHITECTS			
FACADE & ACOUSTICS CONSULTANT		SPECIALIST LIGHTING	
KITCHEN CONSULTANT		SUSTAINABILITY & WASTE MANAGEMENT	
AQUATIC CONSULTANT		SIGNAGE & WAYFINDING	
VERTICAL TRANSPORT		FIRE & LIFE SAFETY	
LANDSCAPING CONSULTANT		TRAFFIC IMPACT STUDY	
PROJECT NAME :		YAS WATER WORLD EXPANSION - ABU DHABI, UAE	
ZONE :			
SECTOR NO :		PLOT NO :	
PROJECT DESCRIPTION :			
DRAWING TITLE :			
DRAWING NO :			
REVISION NO:			
SUBMISSION DATE :		SCALE :	
PROJECT ID :		DRAWING SIZE :	
OFFICIAL USE ONLY :		A0	
OFFICIAL USE ONLY :			

KEY PLAN

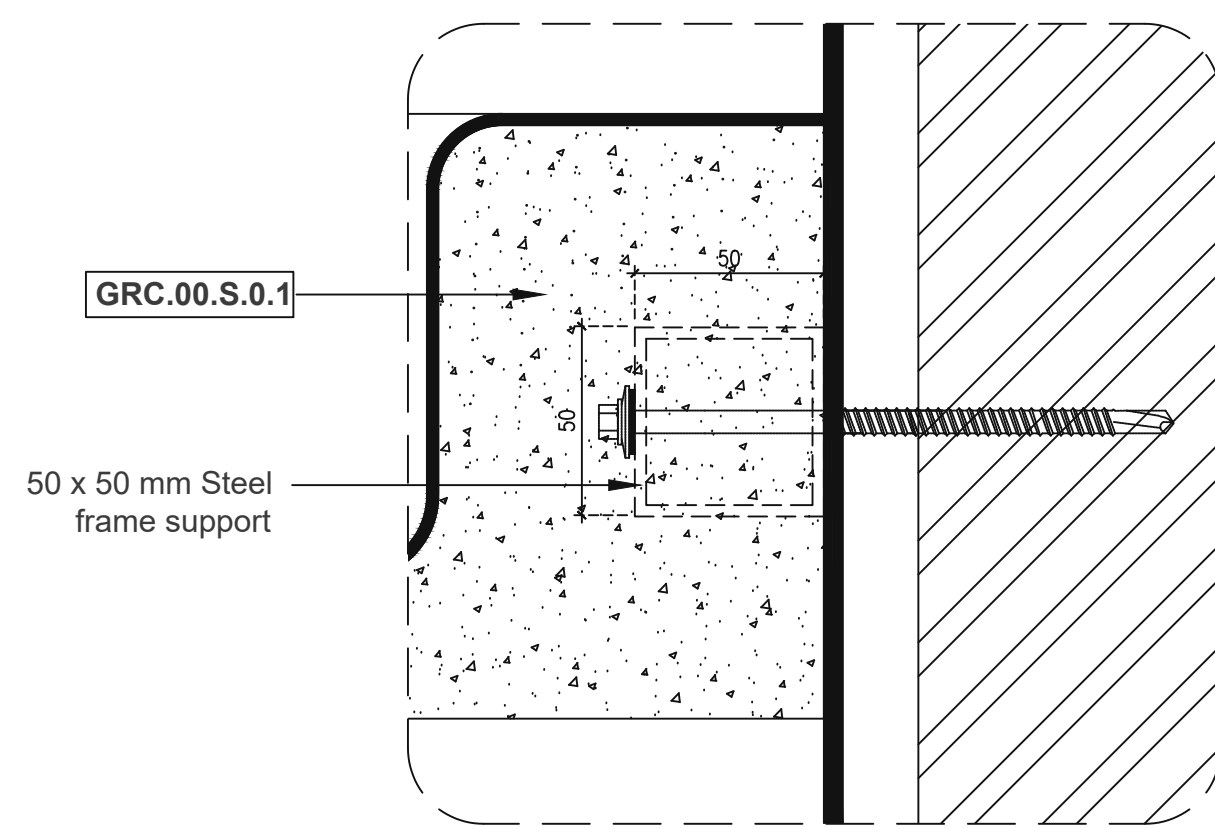
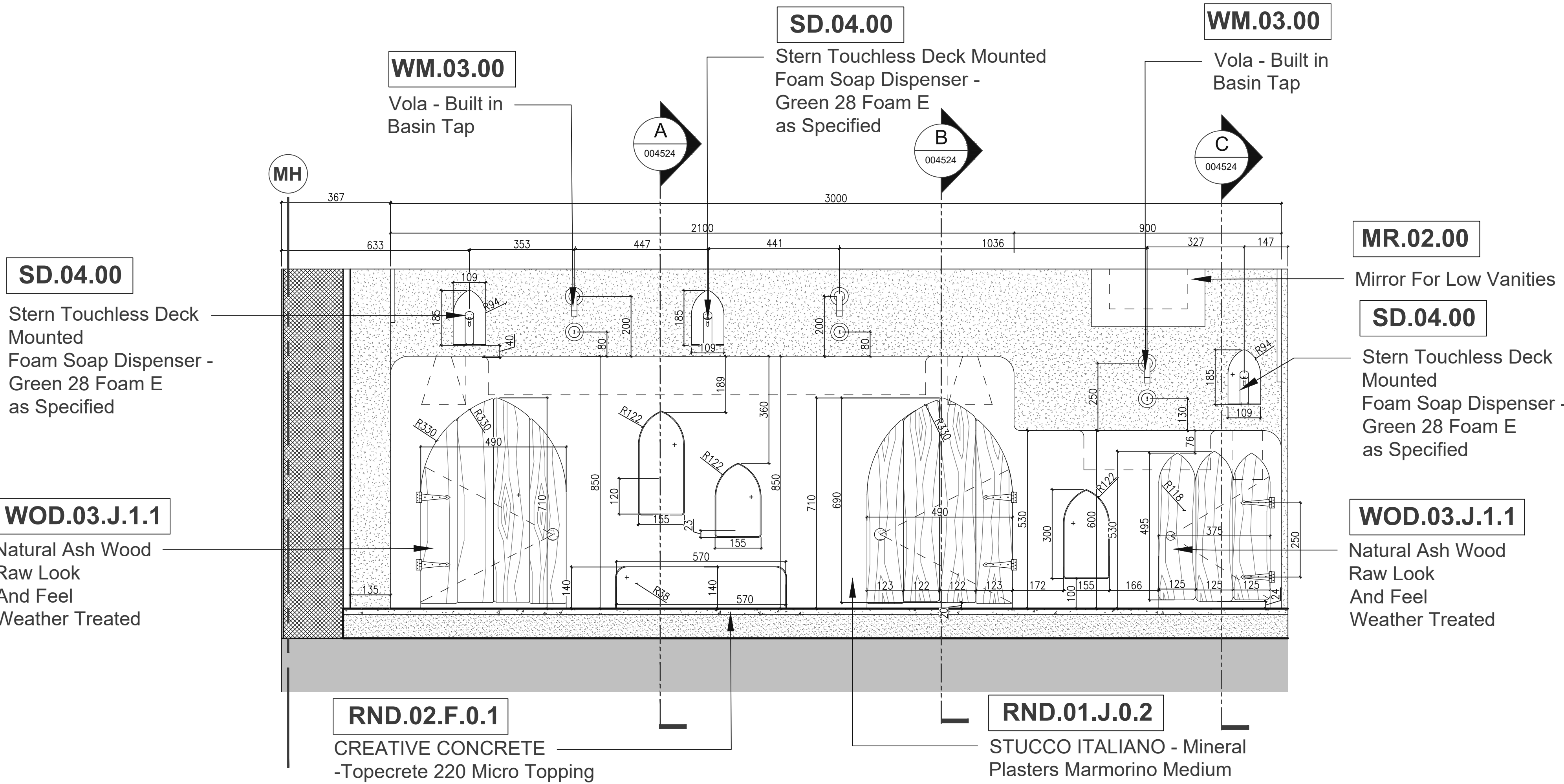

10 BLOW-UP DETAIL 05
SCALE : 1:2

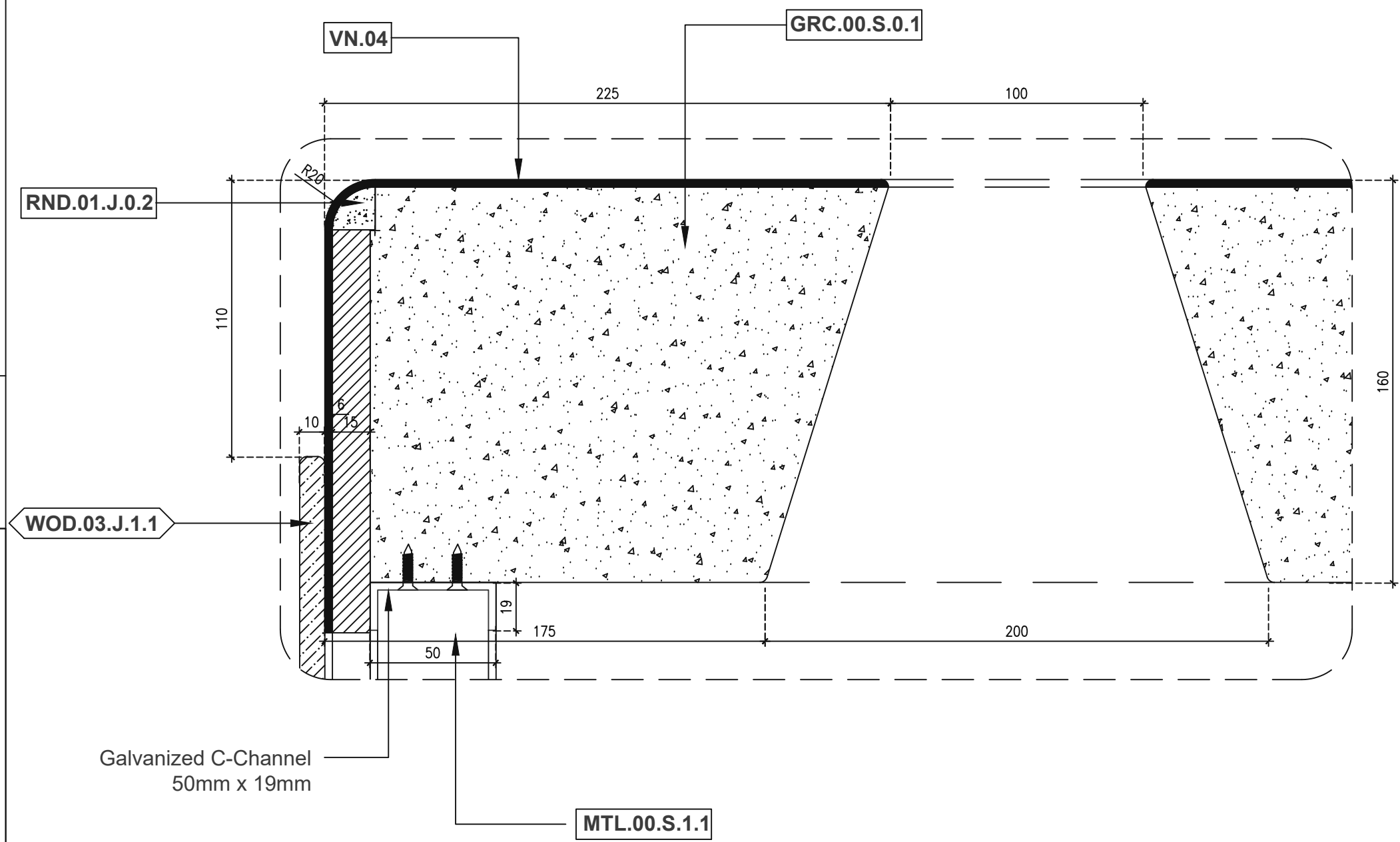

7 BLOW-UP DETAIL 02
SCALE : 1:2

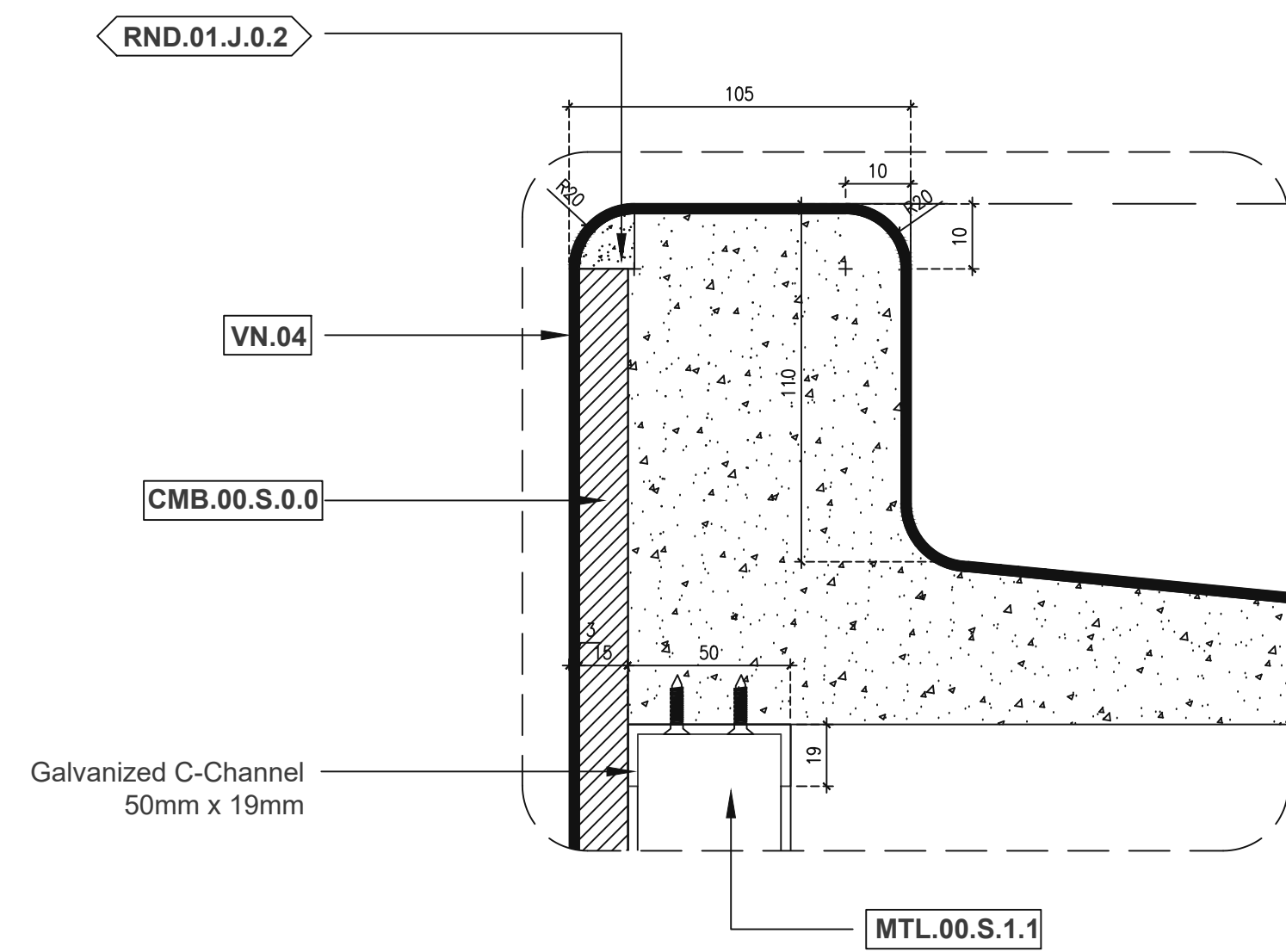

8 BLOW-UP DETAIL 03
SCALE : 1:2

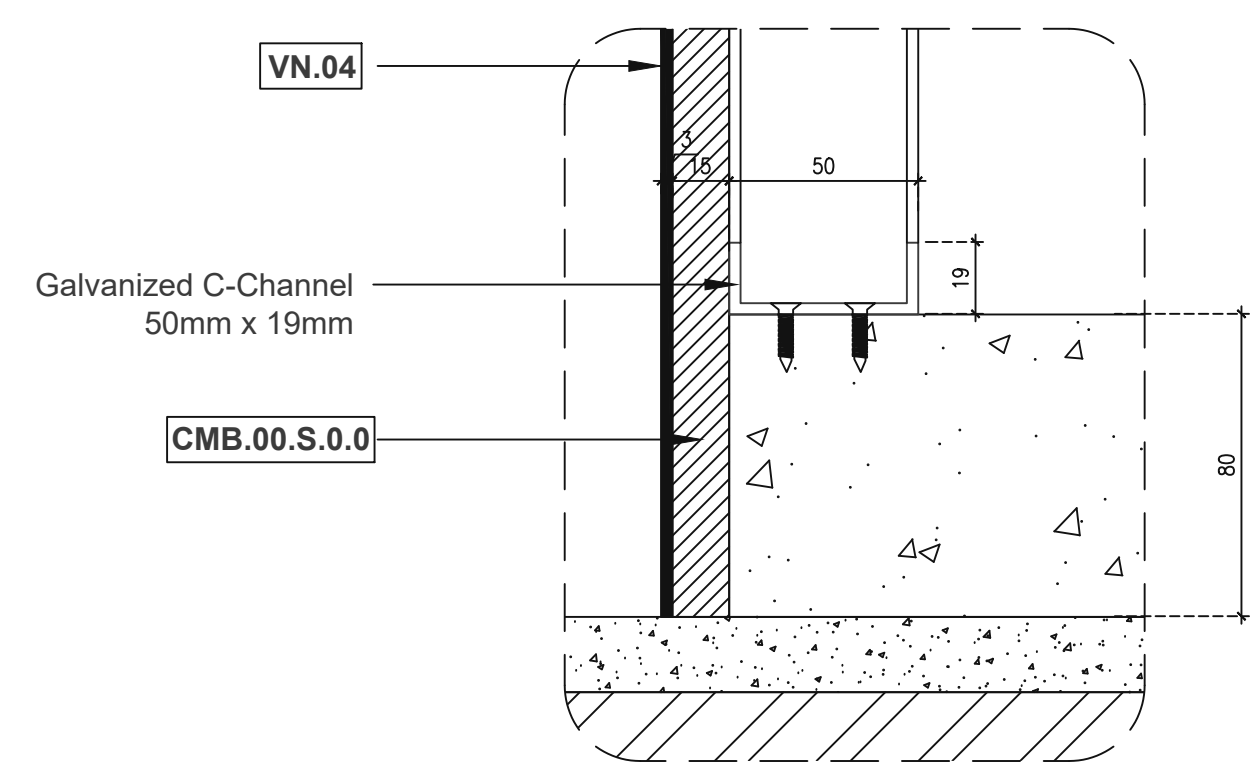

9 BLOW-UP DETAIL 04
SCALE : 1:2

LAND KEY :			MECCA		
GENERAL NOTES:			1. THIS DRAWING MUST BE READ IN CONJUNCTION WITH SPECIFICATION AND SCHEDULES AND RELEVANT ARCHITECTURAL, STRUCTURAL AND MEP DRAWINGS. 2. ANY DISCREPANCY IN OR BETWEEN THE DRAWINGS, SPECIFICATIONS AND SCHEDULES MUST BE BROUGHT TO THE ATTENTION OF THE ENGINEER PRIOR TO UNDERTAKING ANY WORKS. 3. ALL OTHER SERVICES SHOWN ARE PURELY INDICATIVE AND MUST BE VERIFIED AND COORDINATED BY QUALIFIED AGENCIES PRIOR TO THE COMMENCEMENT OF ANY WORK ON SITE. 4. ALL DIMENSIONS SHOWN ARE IN MILLIMETERS AND DO NOT TAKE INTO ACCOUNT APPLIED FINISHES UNLESS SPECIFICALLY INDICATED OTHERWISE. ONLY FIGURED DIMENSIONS TO BE FOLLOWED. 5. FOR SETTING OUT INFORMATION REFER TO ARCHITECTURAL DRAWINGS. DO NOT SET OUT FROM THIS DRAWING. 6. THE CONTRACTOR SHALL SUBMIT COORDINATED SHOP DRAWINGS FOR APPROVAL (BASED ON SITE DIMENSIONS) PRIOR TO COMMENCEMENT OF ANY SITE WORKS OR PLACING OF ANY ORDERS AND/OR MANUFACTURE OF ANY FITTINGS, FIXTURES AND COMPONENTS AS SHOWN. THE CONTRACTOR SHALL ONLY WORK ON COORDINATED AND APPROVED SHOP DRAWINGS. 7. ALL MATERIALS SHALL BE APPROVED BY THE ENGINEER/ARCHITECT PRIOR TO UNDERTAKING ANY WORKS. 8. CONTRACTORS TO PROVIDE ADEQUATE FIXING GROUNDS WITHIN ALL WALLS /PARTITIONS /CEILING TO SUIT AND SUPPORT NEW ELEMENTS THROUGHOUT THE SCHEME. CONTRACTOR TO ENSURE STABILITY OF ALL CONSTRUCTION. 9. ALL CONSTRUCTION AND MATERIALS TO COMPLY WITH CURRENT MUNICIPAL AND CIVIL DEFENSE AND BUILDING REGULATIONS. 10. THIS DRAWING IS ISSUED ON CONDITION THAT IT IS NOT COPIED, REPRODUCED, RETAINED OR DISCLOSED TO ANY UNAUTHORIZED PERSON EITHER WHOLE OR IN PART. 11. FOR SUBSTRATE AND MATERIAL BEHIND ID FINISHES, SEE OTHER DRAWING SPECIFICATIONS BY OTHER DISCIPLINE.		
C0			ISSUED FOR CONSTRUCTION		
REV.NO.			DESCRIPTION		
OWNER:			DATE		
EMPLOYER:			PROJECT MANAGEMENT CONSULTANT		
LEAD DESIGN CONSULTANT :			ARCHITECTS		
FACADE & ACOUSTICS CONSULTANT			SPECIALIST LIGHTING		
KITCHEN CONSULTANT			SUSTAINABILITY & WASTE MANAGEMENT		
AQUATIC CONSULTANT			SIGNAGE & WAYFINDING		
VERTICAL TRANSPORT			FIRE & LIFE SAFETY		
LANDSCAPING CONSULTANT			TRAFFIC IMPACT STUDY		
PROJECT NAME :			YAS WATER WORLD EXPANSION - ABU DHABI,UAE		
ZONE :			M 5E		
SECTOR NO :			Yas South 4 (YS4)		
PLOT NO :			C1		
PROJECT DESCRIPTION :			RIDES FOR RECREATION USE MAXIMUM HEIGHT =45 m , B+G+2 BUILDINGS MAXIMUM BUILDING HEIGHT = 15m		
DRAWING TITLE :			M108 VANITIES DETAILED VIEWS (FAMILY VANITY)		
DRAWING NO :			YWW-DSA-090000-DG-M5E-VC01		
REVISION NO:			C0		
SUBMISSION DATE :			28/02/24		
PROJECT ID :			P250621		
OFFICIAL USE ONLY :			SCALE : As indicated		
OFFICIAL USE ONLY :			DRAWING SIZE : A0		

SANITARY LEGEND by MEP

CODE	DESCRIPTION	APPLICATION AREA
BN.01.01		
BN.01.02		
MR.01.00	MEDICLINICS - Mirror Pivoting	Female, Male and Family Vanity
PD.01.00	MEDICLINICS - Toilet Paper Dispenser	Female, Male and Family Vanity
WM.01.00	VOLA - Built-in Basin Top	Female, Male and Family Vanity
SD.04.00	STERN Touchless Deck Mounted Foam Soap Dispenser - Green 28 Foam E as Specified	Female, Male and Family Vanity
TR.01.02	Chrome Trap	Female, Male and Family Vanity

FINISHES LEGEND

CODE	DESCRIPTION	AREA
CMB.00.S.0.0	KNAUF - Aquapanel 12.5 Cement board	Female, Male and Family Vanity
GRC.00.S.0.1	Pre-cast GRC Concrete	Female, Male and Family Vanity
MTL.00.S.1.1	Galvanized Steel Tubes/Studs	Female, Male and Family Vanity
MTL.01.J.1.1	Black Cast Iron	Female, Male and Family Vanity
RND.01.J.0.2	STUCCO ITALIANO - Tadelakt Green Line	Female, Male and Family Vanity
RND.02.F.0.1	TOPCRETE 220 Micro topping	Female, Male and Family Vanity
WOD.03.J.1.1	Natural Ash Wood Raw Look and Feel weather treated	Female, Male and Family Vanity

HARDWARE LEGEND

HINGE	FINISHING CODE	MATERIAL
HNG.10	MTL.01.J.1.1	Black cast iron
Handle	-	Black
Lock	LAT02	Black

1 MALE TOILET VANITY
SCALE : 1:10

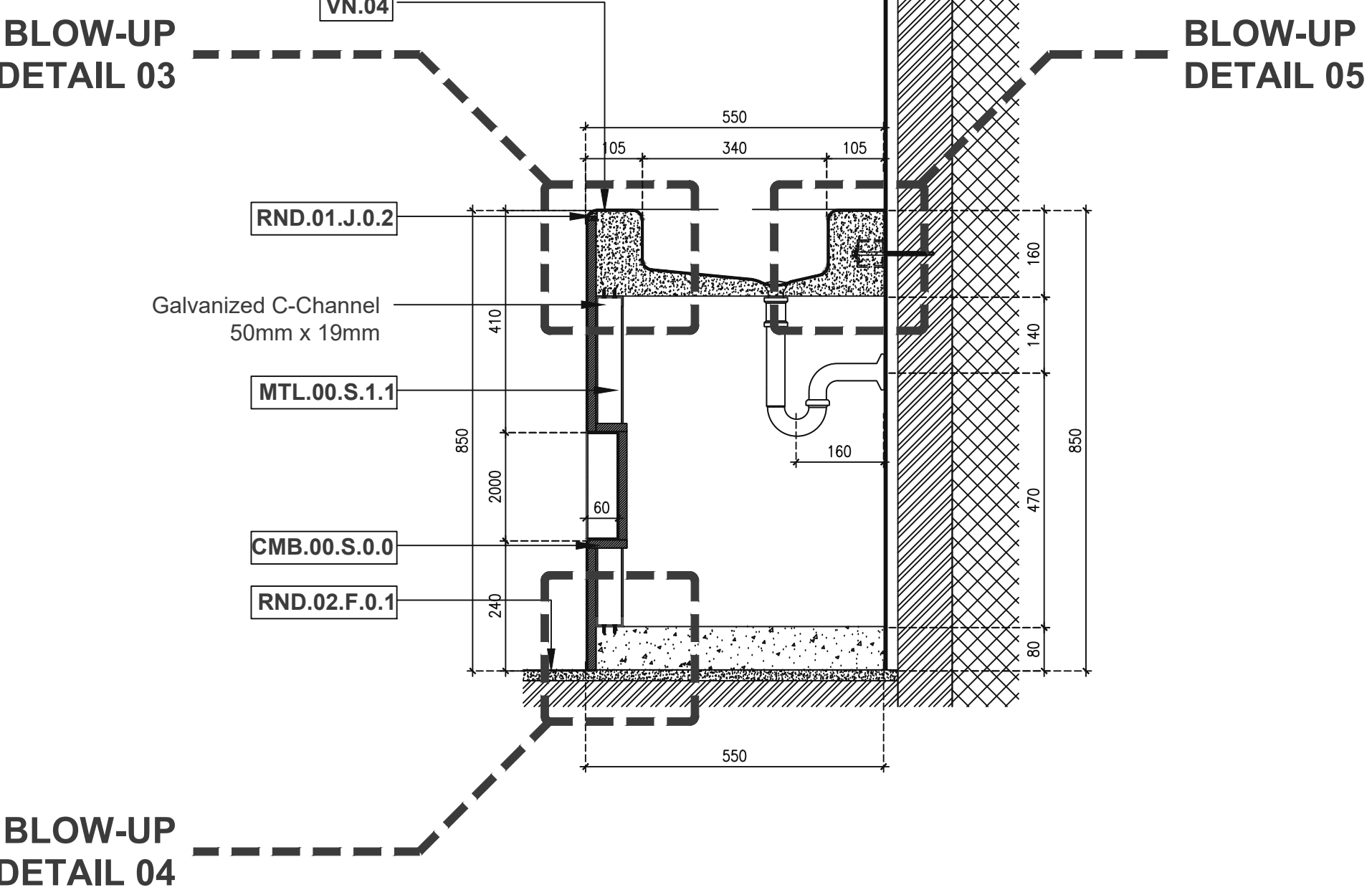

4 SECTION A
SCALE : 1:10

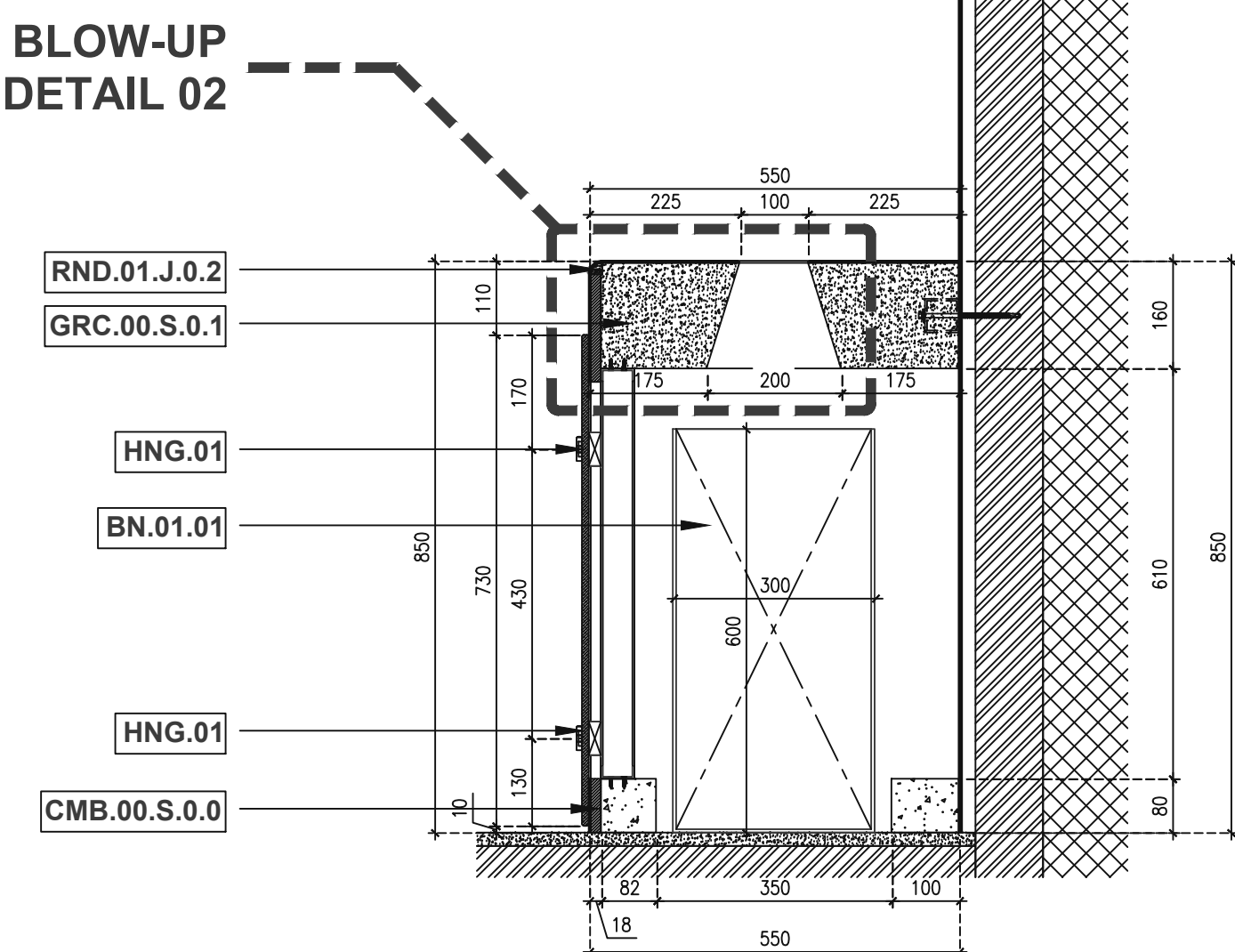

5 SECTION B
SCALE : 1:10

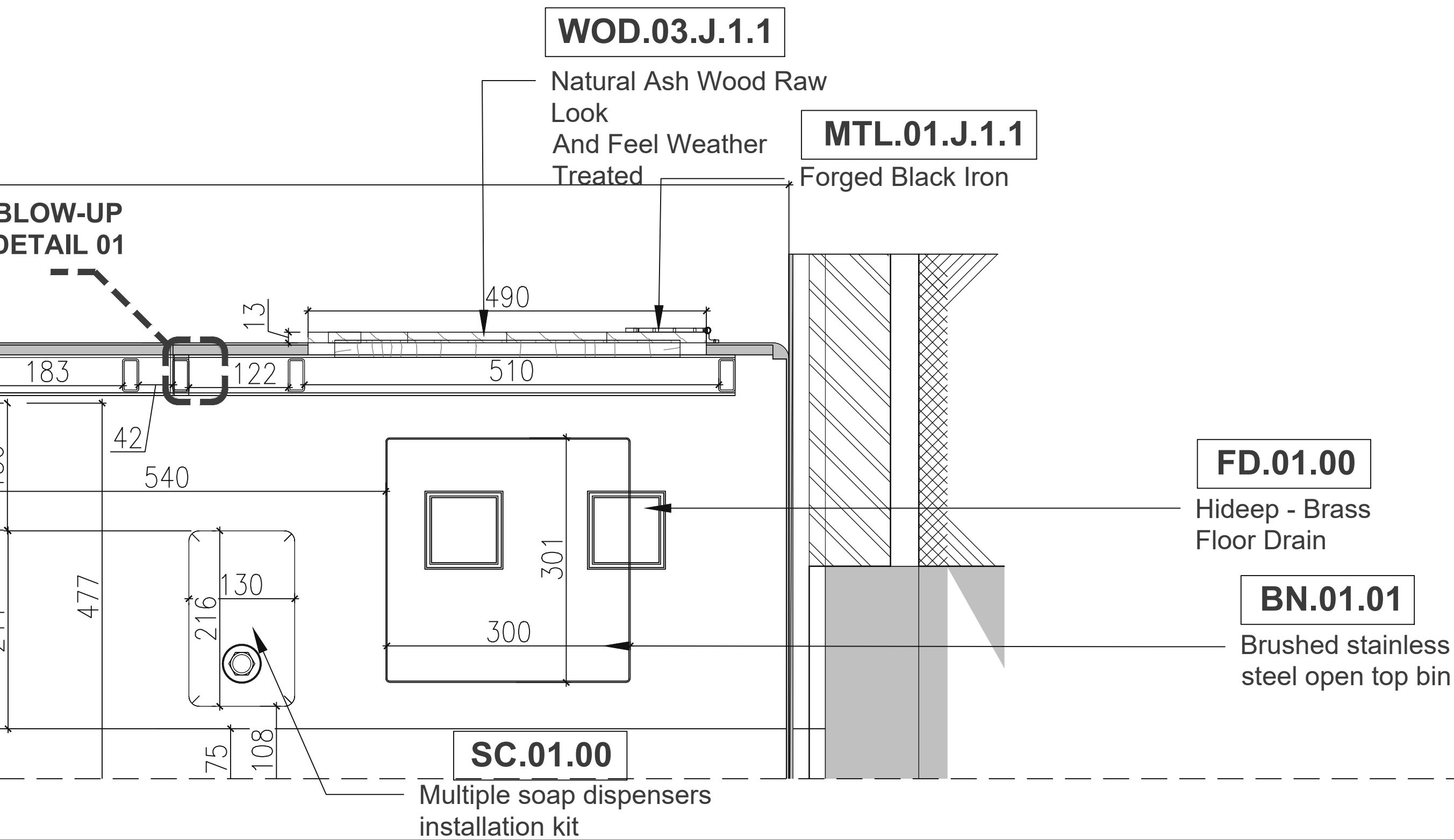

2 BLOW-UP DETAIL 01
SCALE : 1:5

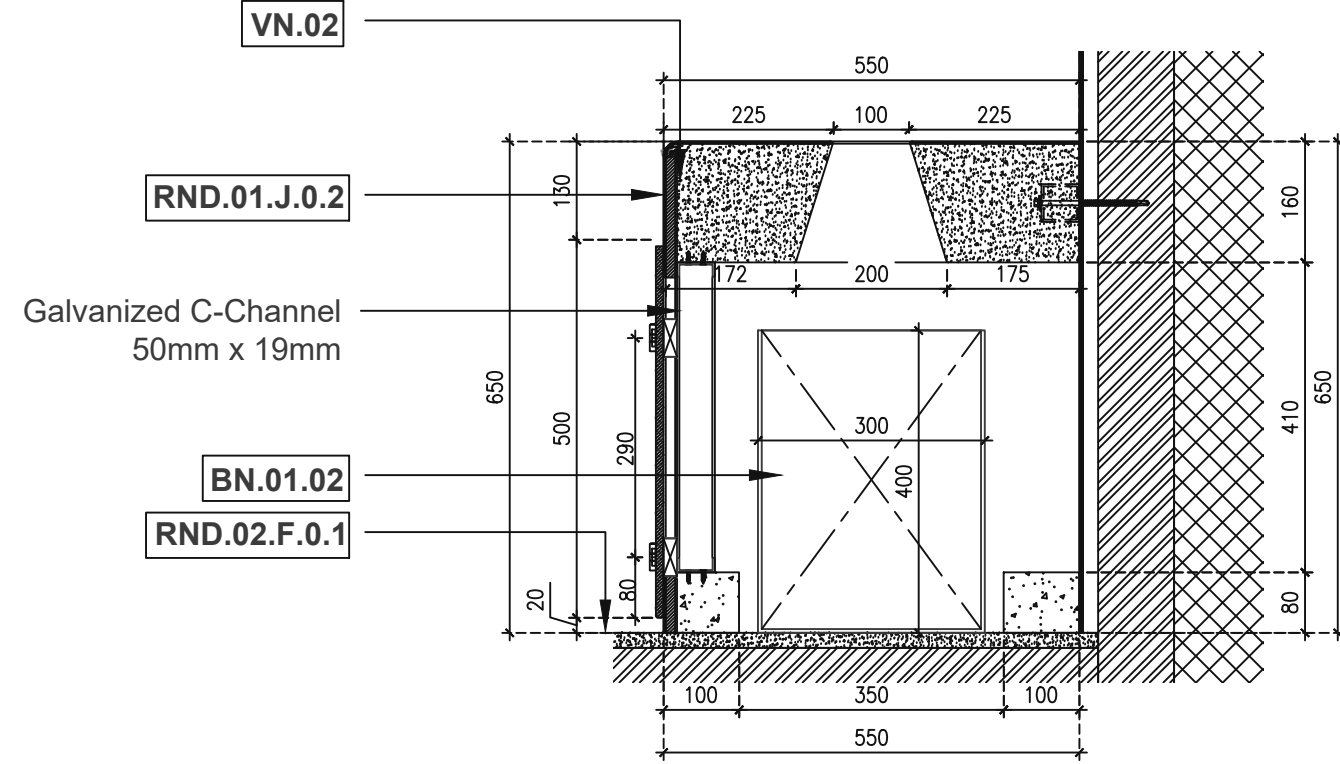

6 SECTION C
SCALE : 1:10

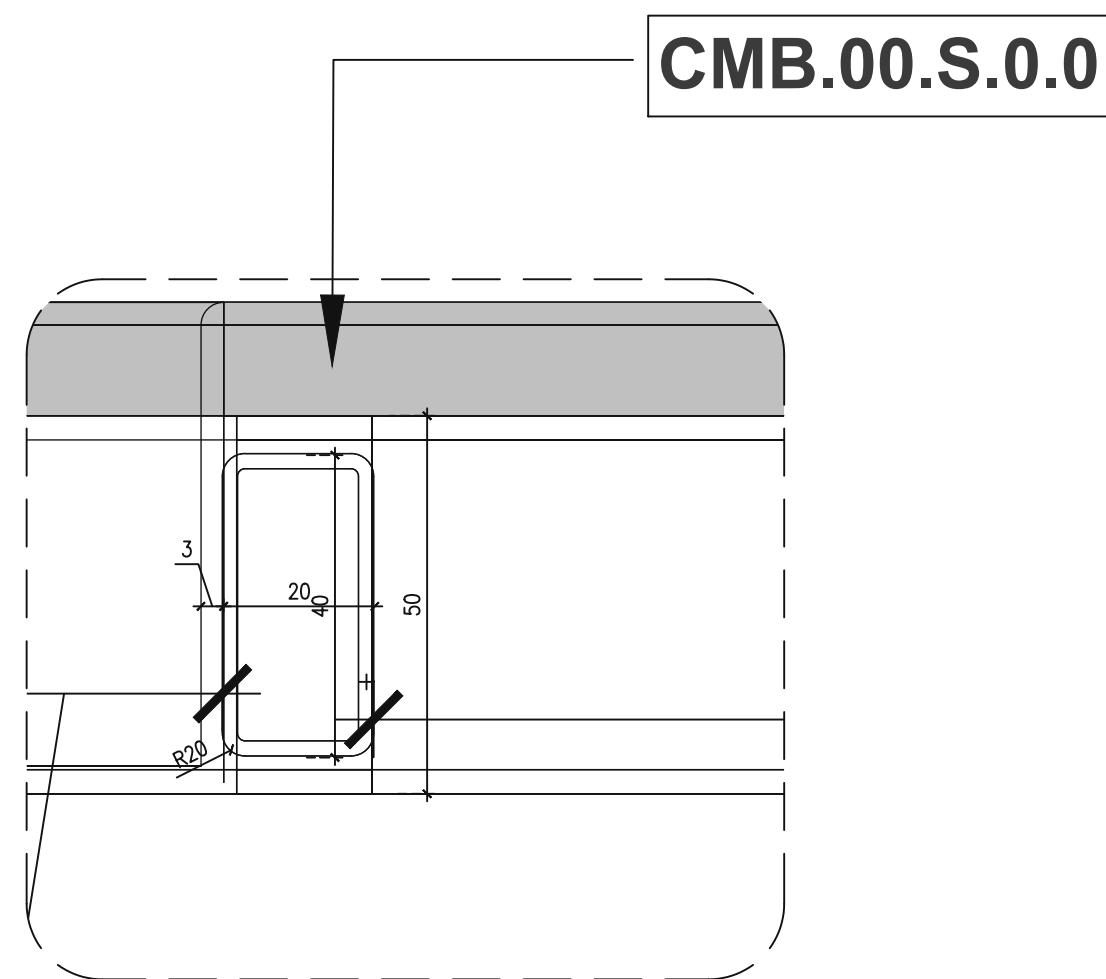

3 BLOW-UP DETAIL 01
SCALE : 1:1